

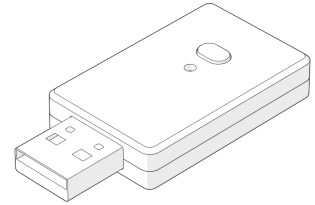

Nedis SmartLife



# 2-in-1 Wireless Car Audio Adapter

Article number: CKAA2400BK



Nedis BV  
Reitscheweg 1, 5232 BX 's-Hertogenbosch, The Netherlands  
service@nedis.com

## Preface

Thank you for purchasing the Nedis CKAA2400BK.

- This document is the user manual and contains all the information for correct, efficient and safe use of the product.
- Ensure you have fully read and understood the instructions in this document before you install or use the product. Keep the packaging and this document for future reference.

○  
○

## Intended use

○

- This product is a 2-in-1 wireless car audio adapter that allows you to convert a factory wired Apple CarPlay or Android Auto system into a fully wireless connection.

The Plug & Play system allows instant wireless connectivity without the need for apps or manual configuration.

The product is intended for use with compatible smartphones running iOS 10 or later, iPhone 6 or later, or Android 11 and later.

This product is intended for indoor use only.

This product is intended to be used in cars and similar vehicles.

This product is not intended for professional use.

Any modification of the product may have consequences for safety, warranty and proper functioning.

## Safety instructions

Ensure you have fully read and understood the instructions in this document before you install or use the product. Keep the packaging and this document for future reference.

### WARNING

Electrical hazard:

- Do not expose the product to water, rain, moisture or high humidity.
- Do not exceed the rated power voltage of the product.
- Do not use the product if a part is damaged or defective. Replace a damaged or defective product immediately.
- Do not immerse the product in water or other liquids.
- Disconnect the product from the power source before cleaning.

Choking hazard:

- Do not let children play with the packaging material. Always keep the packaging material out of the reach of children.
- Keep away from children and animals to avoid chewing or swallowing.

### CAUTION!

Personal safety:

- Only use the product as described in this document.
- Do not operate the device or watch video's while driving.
- Do not open the product, there are no user serviceable parts inside.

### NOTICE

Risk of damaging the product:

- Do not use aggressive chemical cleaning agents when cleaning the product.
- Do not drop the product and avoid bumping.
- Do not expose the product to heat, cold or direct sunlight.

## Product description

Main parts (image **A**)

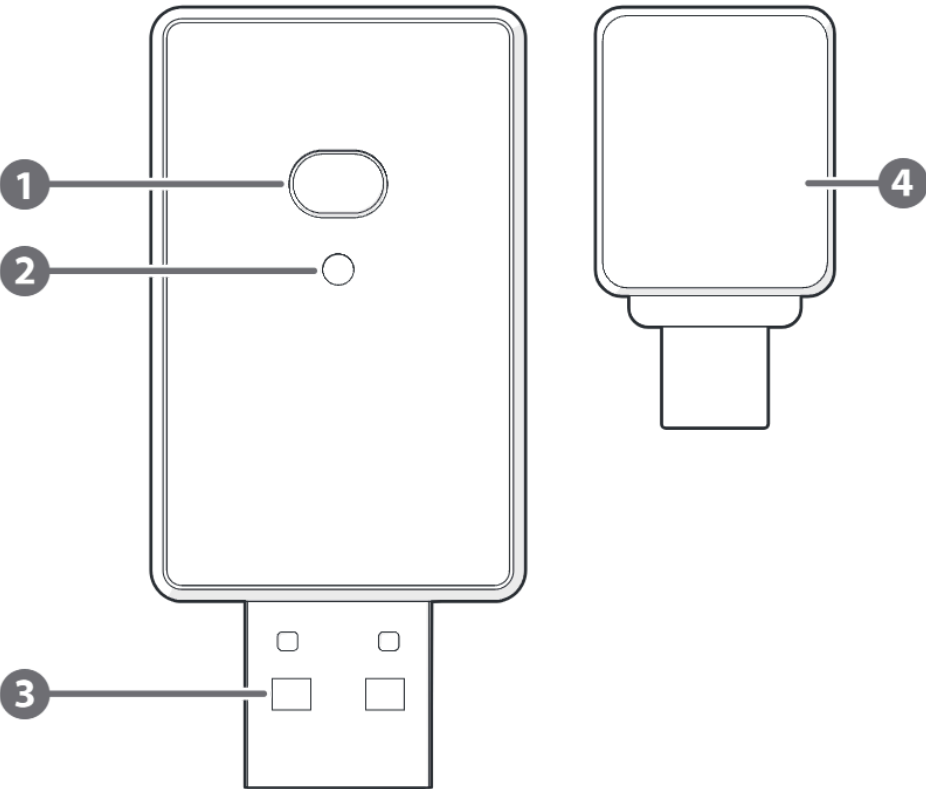

A

- 1 Smart button
- 2 Indicator LED
- 3 USB-A
- 4 USB-A to USB-C adapter

Specifications

|                         |                                   |
|-------------------------|-----------------------------------|
| Product                 | 2-in-1 Wireless Car Audio Adapter |
| Article number          | CKAA2400BK                        |
| Dimensions              | 50 x 24 x 8,7 mm                  |
| Input voltage / current | 5 V / 1.0 A                       |

|                                     |                                      |
|-------------------------------------|--------------------------------------|
| Wi-Fi frequency                     | 802.11 a/b/g/n/ac, 2.4 G + 5 G       |
| Connection                          | USB-A™                               |
| Adapter                             | USB-C™                               |
| Wireless Apple CarPlay requirements | iPhone 6 and above, iOS 10 and above |
| Wireless Android Auto requirements  | Android 11.0 and above               |
| Power consumption                   | 2 W                                  |
| Standby power consumption           | 0.7 W                                |
| Power consumption in OFF mode       | 0 W                                  |

## Installation

- 
- 
- Check the contents of the package
- 
- Check that all parts are present and that no damage is visible on the parts. If parts are
- missing or damaged, contact the Nedis B.V. service desk via the website: [www.nedis.com](http://www.nedis.com).
- 
- 
- 
- Installing the product
- 
- 1. Start the vehicle.
- 2. Insert the product into the USB-A port of the vehicle.  
The indicator LED **A2** lights up blue.

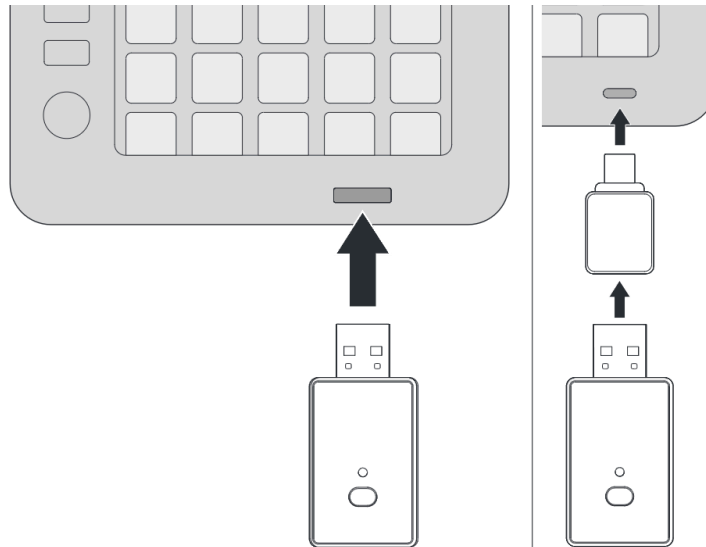

- i** If the vehicle only has a USB-C port, use the USB-A to USB-C adapter **A4** to insert the product.

## Connecting the product

- i** Apple CarPlay requires an iPhone 6 or newer model with iOS 10 or newer to operate.
- i** Android Auto requires a model that supports Android 11 or newer to operate.

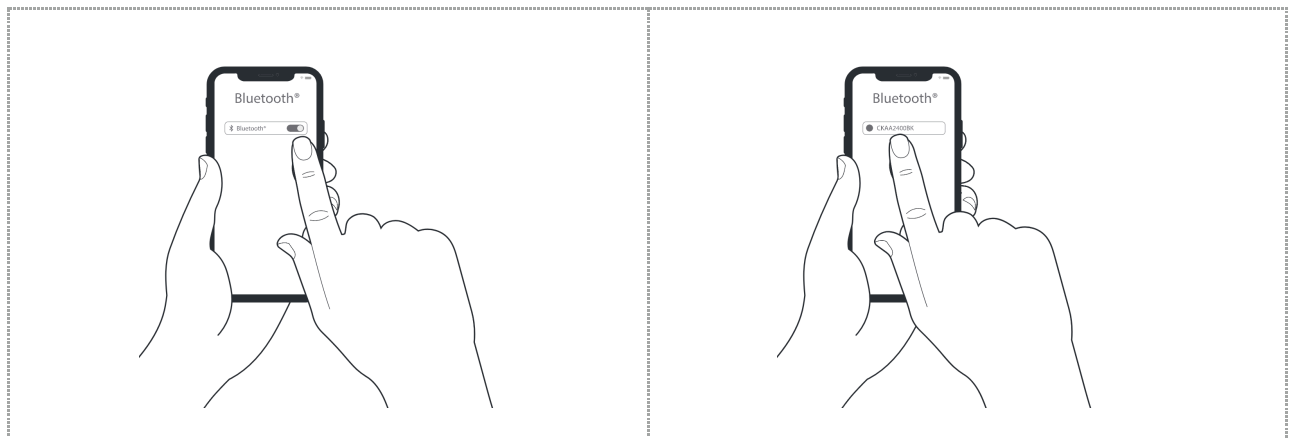

1. Activate Wi-Fi on your smartphone.
2. Activate Bluetooth pairing mode on your smartphone.  
The indicator LED **A2** pulses green.
3. Select the product name (CKAA2400BK) to connect with the product.
4. Agree to all requests.  
The indicator LED **A2** lights up green when the product is successfully connected.

## Upgrading firmware while the product is connected to the vehicle

1. Make sure your smartphone is connected to the internet.
2. Open an internet browser on your smartphone.
3. Enter 192.168.1.101 in the address bar and press Search.  
The firmware upgrade page opens.
4. Tap the Update button to start the firmware upgrade.  
The indicator LED **A2** pulses green and red.
- i** The indicator LED **A2** lights up white when the upgrade is complete.

## Upgrading firmware while the product is not connected to the vehicle

1. Make sure your smartphone is connected to the internet.
2. Plug the product into a compatible USB port with power.
- i** Use the adapter **A4** if necessary.
- i** Do not disconnect the power source while upgrading.
3. Connect the product to your smartphone (see chapter Connecting the product)
4. Open an internet browser on your smartphone.
5. Enter 192.168.1.101 in the address bar and press Search.  
The firmware upgrade page opens.
6. Tap the Update button to start the firmware upgrade.  
The indicator LED **A2** pulses green and red.
- i** The indicator LED **A2** lights up white when the upgrade is complete.
7. Unplug the product.
- i** Reconnect the product to your smartphone after the upgrade.

## Upgrading firmware for Android

### Upgrading firmware while the product is connected to the vehicle

1. Make sure your smartphone is connected to the internet.
2. Open an internet browser on your smartphone.
3. Enter 192.168.1.101 in the address bar and press Search.  
The firmware upgrade page opens.

The indicator LED **A2** lights up white when the upgrade is complete.

## Upgrading firmware while the product is not connected to the vehicle

1. Make sure your smartphone is connected to the internet.
2. Plug the product into a compatible USB port with power.
- i** Use the adapter **A4** if necessary.
- i** Do not disconnect the power source while upgrading.
3. Press and hold the smart button **A1** for 5 seconds to enter P2P mode.  
The indicator LED **A2** lights up red.
4. Connect the product to your smartphone (see chapter Connecting the product)
5. Open an internet browser on your smartphone.
6. Enter 192.168.1.101 in the address bar and press Search.  
The firmware upgrade page opens.
7. Tap the Update button to start the firmware upgrade.  
The indicator LED **A2** pulses green and red.
- i** The indicator LED **A2** lights up white when the upgrade is complete.
8. Unplug the product.
- i** Re-connect the product to your smartphone after the upgrade.

## Use

### Using the product

The product automatically connects to your smartphone when powered on. Use Apple CarPlay or Android Auto to access apps, music, messages, voice control and more through the vehicle's screen.

Press the smart button **A1** to disconnect the current connection.

## Indicator LED

**Blue**

Power on / Auto communication  
succeeded (not for Android Auto)

|                     |                            |
|---------------------|----------------------------|
| Pulsing green       | Smartphone connecting      |
| Green               | Smartphone connected       |
| Pulsing green / red | Firmware updating          |
| White               | Firmware update complete   |
| Pulsing red         | Unexpected firmware update |
| Red                 | P2P mode                   |

## Factory reset

Press and hold the smart button **A1** for 10 seconds to clear all data and restore the factory settings.

- 
- 
- Reporting issues
- 
- 1. Make sure your smartphone is connected to the internet.
- 2. Connect the product to your smartphone (see chapter Connecting the product).
- 3. Open an internet browser on your smartphone.
- 4. Enter 192.168.1.101 in the address bar and press Search.
- The firmware upgrade page opens.
- 5. Tap Upload log.
- 6. Fill in the table.
- 7. Copy the issue case number.
- 8. Paste the issue case number in the table.
- 9. Tap Send.

## Reporting issues in P2P mode

1. Make sure your smartphone is connected to the internet.
2. Set the product to P2P mode (see chapter Upgrading firmware while the product is not connected to the vehicle (Android)).
3. Select Upload log.
4. Fill in the table.



# Maintenance

Disconnect the product before cleaning.

Clean the product regularly with a soft, clean, dry cloth. Avoid abrasives that can damage the surface.

Do not use aggressive chemical cleaning agents such as ammonia, acid or acetone when cleaning the product.

# Troubleshooting

| Problem  | Possible cause                                   | Possible solution  |
|--|--|--|
| The product does not automatically connect to your smartphone. | Your smartphone is not connected to the product. | Connect your smartphone to the product. (see chapter Connecting the product) |
|  | Wi-Fi is switched off on your smartphone.        | Switch on Wi-Fi.   |
|  | Bluetooth is switched off on your smartphone.    | Switch on Bluetooth.   |
| Connection is unstable.  | Bad internet connection.                         | Check your internet connection.  |
|  | Old iOS or Android.                              | Update the software to the most recent version.                              |

# Disposal



collection point. Do not dispose of the product with household waste. For more information, contact the retailer or the local authority responsible for the waste management.

## Disclaimer

Designs and specifications are subject to change without notice. All logos, brands and product names are trademarks or registered trademarks of their respective owners and are hereby recognised as such.

## Declaration of Conformity

We, Nedis B.V. declare as manufacturer that the product CKAA2400BK from our brand Nedis<sup>®</sup>, produced in China, has been tested according to all relevant CE standards and regulations and that all tests have been passed successfully. This includes, but is not

- limited to the RED 2014/53/EU regulation.

- 

- The complete Declaration of Conformity (and the safety datasheet if applicable) can be found and downloaded via:

- 

- [nedis.com/ckaa2400bk#support](https://nedis.com/ckaa2400bk#support)

- 

- 

- 

-